

635nm~638nm 300mW MM Fiber Coupled Laser Diodes | Red Laser Diode
635nm 300mW~350mW Multi-mode Coaxial Pigtailed LD Module| 105um Fiber Core
RWLP-635-300m-M-B

635nm Pigtailed Diode Laser		300mW/MMF	
PARAMETER	SYMBOL	VALUE	UNIT
MAX Reverse Voltage	V_r	2.0	V
Operating Temperature	T_{op}	0~ +40	°C
Storage Temperature	T_{stg}	-40~ +85	°C
Lead soldering temperature (10 sec.)	T_{is}	260	°C
Features: <ul style="list-style-type: none"> ● 638nm ● MM Fiber ● B82 Package 			
Applications: <ul style="list-style-type: none"> ● Medical Laser Treatment ● Others 			
Specifications	RWLP-635-300m-M-B		
	Min	Type	Max
Center Wavelength@25°C	630nm	638nm	645nm
Spectral Width (FWHM)	----	2.0nm	----
Output Power	----	300mW	----
Fiber Core	105um		
Numerical aperture	0.22		
Fiber Connector	FC/SC/SMA905		
Fiber Length	>80cm		
Threshold Current (Typ.)	----	180mA	250mA
Operating Current (Typ.)	----	800mA	850mA
Operating Voltage	----	2.2V	2.8V
Recommended Operating Temperature	25°C		
Package Style	B82		

B82 Package View:

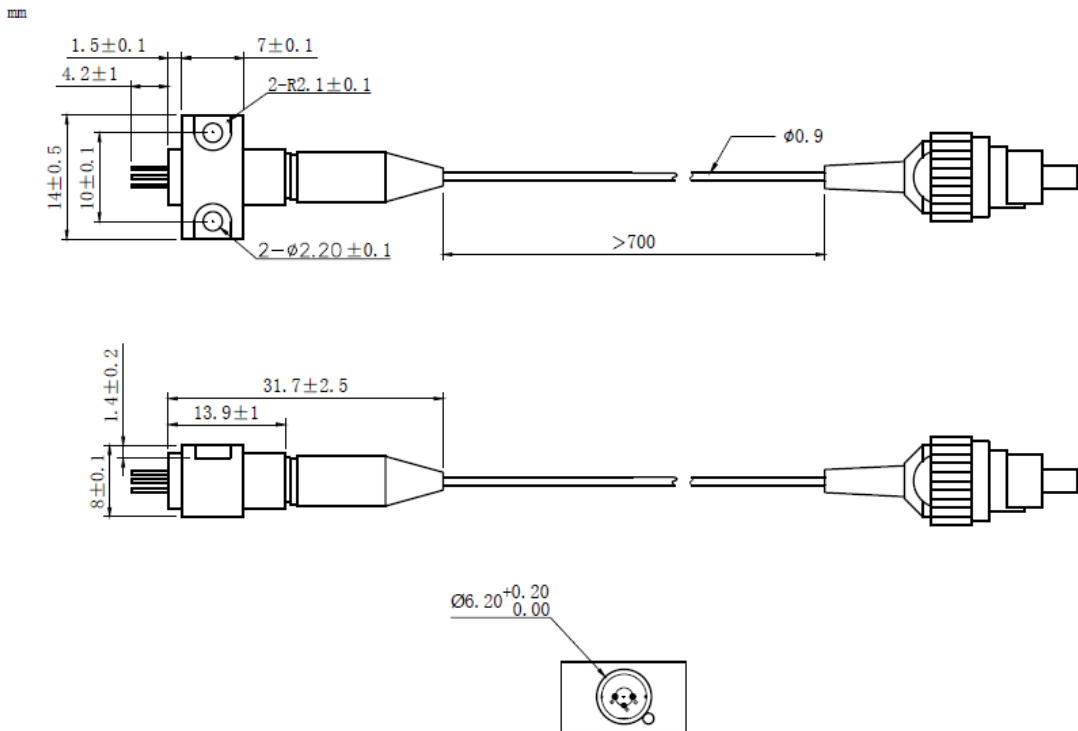

PIN Bottom View:

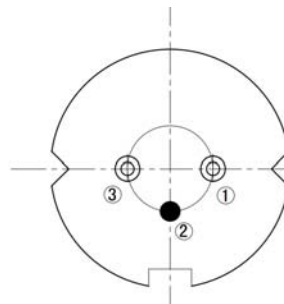

1	LD(+)
2	GND
3	LD(-)

Electrically shorten LD module and store in non-extreme conditions.
Suggest using the constant current power supply.

