

650nm~660nm 100mW SM Fiber Coupled Laser Diode with 4um Single Mode Fiber

658nm 100mW High Power Pigtailed Diode Laser with Coaxial Package | High Power SM Red LD Module

RWLP-650-100m-4

| 650nm Pigtailed Diode Laser | | 100mW/SM Fiber | |
|---|--|----------------|-------|
| PARAMETER | SYMBOL | VALUE | UNIT |
| Reverse Voltage | V_r | 2.0 | V |
| Operating Temperature | T_{op} | -10~+60 | °C |
| Storage Temperature | T_{stg} | -40~+85 | °C |
| Lead soldering temperature (10 sec.) | T_{is} | 260 | °C |
| Features: <ul style="list-style-type: none"> ● 650nm ● Single Mode Fiber ● Coaxial or B82 Package |  | | |
| Applications: <ul style="list-style-type: none"> ● Medical Laser Treatment ● Other | | | |
| Specifications | RWLP-650-100m-4 | | |
| | Min | Type | Max |
| Center Wavelength@25°C | ±5nm | 658nm | ±10nm |
| Spectral Width (FWHM) | ---- | 2.0nm | ---- |
| Output Power | ---- | 100mW | ---- |
| Fiber Type | Single Mode Fiber | | |
| Fiber Core | 4um | | |
| Recommend Operating Temperature | 25°C | | |
| Fiber Connector | FC/SC/SMA905 | | |
| Fiber Length | ---- | 80cm | 100cm |
| Threshold Current | ---- | 55mA | 85mA |
| Operating Current | ---- | 220mA | 240mA |
| Operating Voltage | ---- | 2.8V | 3.5V |
| Package Style | Coaxial or B82 | | |

Coaxial Package View: (Part Number: RWLP-650-100m-4)

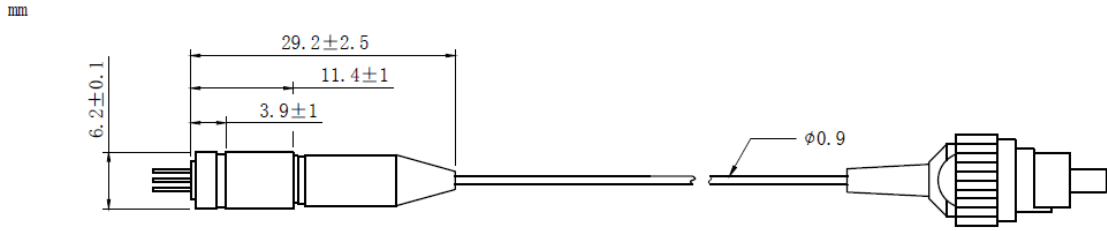

B82 Package View: (Part Number: RWLP-650-100m-4-B)

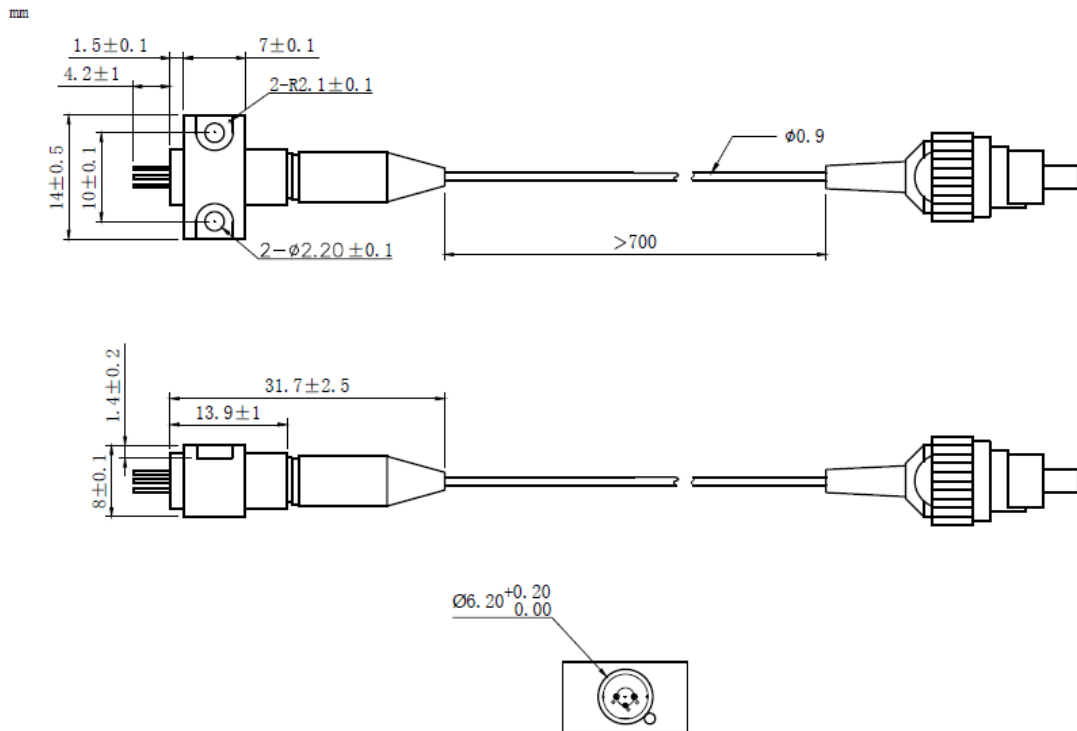

PIN Bottom View:

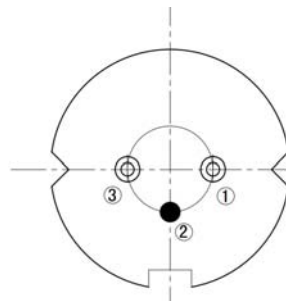

| | |
|---|-------|
| 1 | LD(+) |
| 2 | LD(-) |
| 3 | NC |

Electrically shorten LD module and store in non-extreme conditions.
Suggest using the constant current power supply.

