

## 1550nm 2mw SM FP Coaxial Pigtail Laser Diode

1550nm 2mw Fiber Coupled LD with single mode fiber

WSLP-1550-002m-9-FP

Wavespectrum laser inc.

[www.wavespectrum-laser.com](http://www.wavespectrum-laser.com)

PARAMETER	SYMBOL	VALUE	UNIT
LD Reverse Voltage	$V_r$	2.0	V
PD Operating Current	$I_{r(PD)}$	2.0	mA
PD Reverse Voltage	$V_{r(PD)}$	15	V
Operating Temperature	$T_{op}$	-10 ~ +85	°C
Storage Temperature	$T_{stg}$	-40 ~ +85	°C
Lead soldering temperature (10 sec.)	$T_{is}$	260	°C
<b>Features:</b> <ul style="list-style-type: none"> <li>● 1550nm</li> <li>● FP Laser Diode</li> <li>● Built-in Monitor</li> <li>● 9um Fiber Core</li> <li>● Isolation Optional</li> <li>● 1.25Gb/s , 2.5Gb/s Optional</li> <li>● Coaxial/Receptacle package</li> </ul>			
<b>Applications:</b> <ul style="list-style-type: none"> <li>● Test Equipments</li> <li>● Optical Bidi Module and Optical Receiver</li> <li>● Optical Transmitter of Analog Signal</li> <li>● Optical Transmitter of Data Signal</li> </ul>			
<b>Specifications</b>		<b>WSLP-1550-002m-9-FP</b>	
		Min	Type
Center Wavelength@25°C		1530nm	1550nm
Laser Type		<b>FP</b>	
Output Power		----	2mw
Fiber Core		<b>9um</b>	
Threshold Current (Typ.) $I_{th}$		5mA	15mA
Operating Current		----	25mA
Forward Voltage		----	1.1V
Monitor Current		0.1mA	----
PD Capacitance		----	10pF
PD Dark Current		----	0.1uA
Side Mode Suppression Ration		30dB	35dB
Package Style		Pigtail	Receptacle
Data Rate		1.25Gb/s	2.5Gb/s
Isolation		with	without
Connector Pin		TypeA	TypeB
Fiber Connector		FC/SC/ST/LC/MU	



### Coaxial Package View

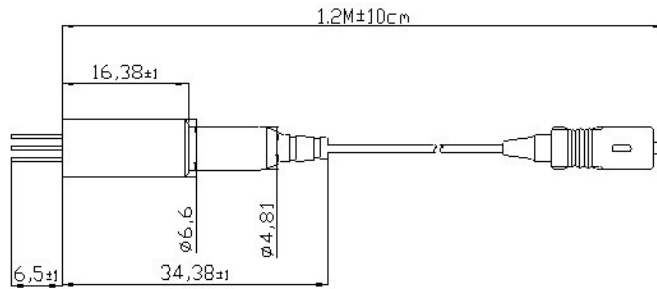

### Bottom View

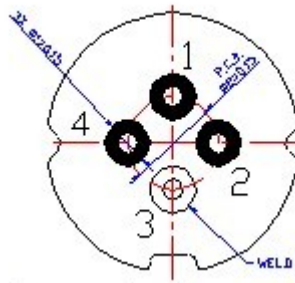

TYPE A  
PIN ASSIGNMENT:

1	PD Cathode
2	PD Anode
3	LD Anode, GND
4	LD Cathode

Electrically shorten LD module and store in non-extreme conditions.  
Suggest using the constant current power supply.



Please contact us:

Website: [www.wavespectrum-laser.com](http://www.wavespectrum-laser.com) (for more detailed information)

Email: [info@wavespectrum-laser.com](mailto:info@wavespectrum-laser.com) (for inquiry about this product)

