

**670nm 10mW MM Fiber Coupled Diode Laser Module | Red LD Module | Heat-sink Optional**
**670nm Coaxial Pigtailed Laser Diode with Multi-mode Fiber | 62.5um, 105um Fiber Optional**
**WSLP-670-010m-M-PD**
**Wavespectrum Laser Group**
**www.wavespectrum-laser.com**

670nm Pigtailed Diode Laser		10mW/MM Fiber		en.wavespectrum-laser.com.cn	
PARAMETER	SYMBOL	VALUE		UNIT	
Reverse Voltage	$V_r$	2.0		V	
Operating Temperature	$T_{op}$	-10~+60		°C	
Storage Temperature	$T_{stg}$	-40~+85		°C	
Lead soldering temperature (10 sec.)	$T_{is}$	260		°C	
<b>Features:</b> <ul style="list-style-type: none"> <li>🔸 670nm</li> <li>🔸 MM Fiber</li> <li>🔸 Coaxial or B82 Package</li> </ul>					
<b>Applications:</b> <ul style="list-style-type: none"> <li>🔸 Medical Laser Treatment</li> <li>🔸 Aiming Beam</li> <li>🔸 Others</li> </ul>					
<b>Specifications</b>	<b>WSLP-670-010m-M-PD</b>				
	Min	Type	Max		
Center Wavelength@25°C	660nm	670nm	680nm		
Recommended work Temperature	25°C				
Output Power	----	10mW	----		
Fiber Type	Multi-mode Fiber				
Fiber Core	105um (62.5um Optional)				
Monitor Current	----	0.3mA	----		
PD Reverse Voltage	----	----	30V		
Fiber Connector	FC/SC/SMA905				
Fiber Length	----	80cm	100cm		
Threshold Current (Typ.)	----	20mA	35mA		
Operating Current (Typ.)	----	40mA	45mA		
Operating Voltage	----	2.4V	3.0V		
Package Style	Coaxial or B82				

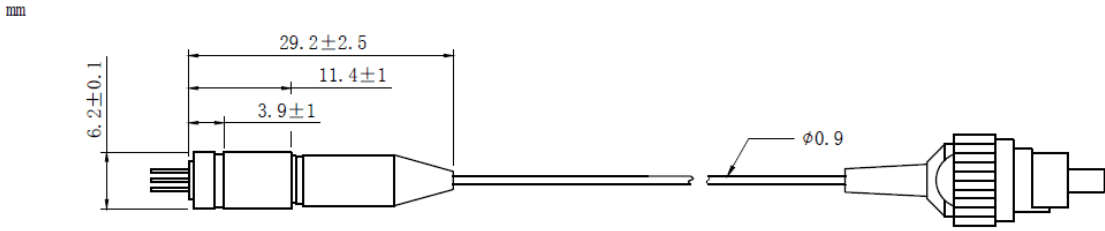

**Coaxial Package View: (Part Number: WSLP-670-010m-M-PD)**



**B82 Package View: (Part Number: WSLP-670-010m-M-B-PD)**



**PIN Bottom View:**

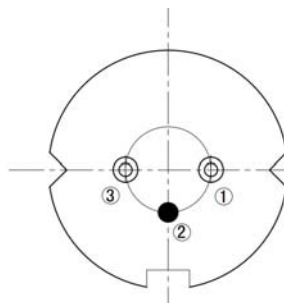

1	LD(-)
2	LD(+)&PD(-)
3	PD(+)



Electrically shorten LD module and store in non-extreme conditions.  
Suggest using the constant current power supply.

