

905nm 50mW~60mW Multi-mode Pigtailed Laser Diode with Coaxial Package | Built-in Photodiode
905nm~915nm MM Fiber Coupled LD with Multi-mode Fiber | 50um, 62.5um, 105um Optional | With PD
WSLP-905-050m-M-PD **Wavespectrum Laser Group** **www.wavespectrum-laser.com**

905nm Pigtailed Diode Laser		50mW/MM Fiber		Wavespectrum Laser Group	
PARAMETER	SYMBOL	VALUE		UNIT	
Reverse Voltage	V_r	2.0		V	
Operating Temperature	T_{op}	-10~+60		°C	
Storage Temperature	T_{stg}	-40~+85		°C	
Lead soldering temperature (10 sec.)	T_{is}	260		°C	
Features: <ul style="list-style-type: none"> ● 905nm ● Multi-mode Fiber ● Coaxial or B82 Package ● Built-in PD 					
Applications: <ul style="list-style-type: none"> ● Medical Laser Treatment ● Sensor ● Others 					
Specifications	WSLP-905-050m-M-PD				
	Min	Type	Max		
Center Wavelength@25°C	±5nm	905nm	±10nm		
Recommend Operating Temperature	25°C				
Output Power	----	50mW	----		
Fiber Type	Multi-mode				
Fiber Core	105um(50um,200um Optional)				
Monitor Current	----	0.3mA	----		
PD Reverse Voltage	----	----	30V		
Fiber Connector	FC/SC/SMA905				
Fiber Length	----	80cm	100cm		
Threshold Current (Typ.)	----	25mA	50mA		
Operating Current (Typ.)	----	130mA	150mA		
Operating Voltage	----	1.9V	2.4V		
Package Style	Coaxial or B82				
Photodiodes	Built-in				

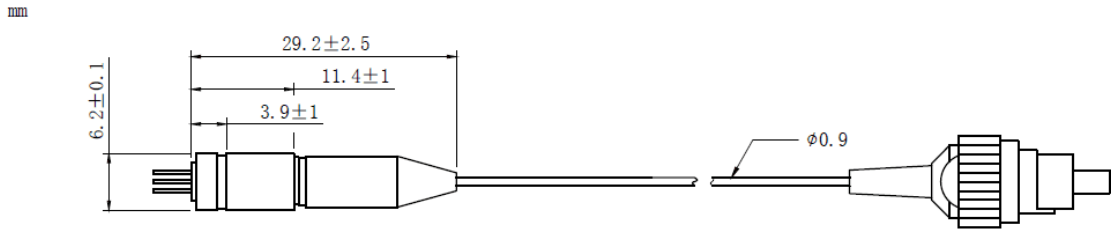
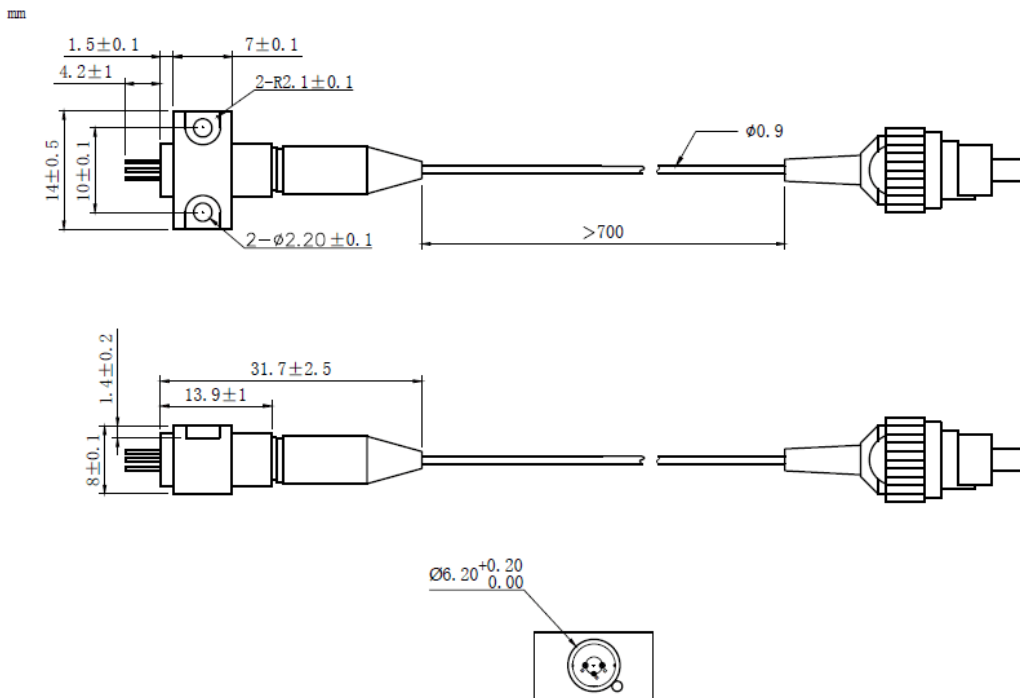
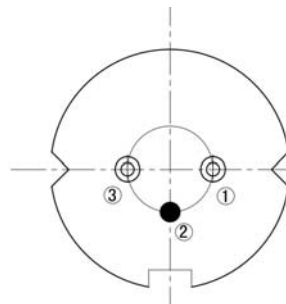

Coaxial Package View: (Part Number: WSLP-905-050m-M-PD)

B82 Package View: (Part Number: WSLP-905-050m-M-B-PD)

PIN Bottom View:

1	LD(-)
2	LD(+)&PD(-)
3	PD(+)



Electrically shorten LD module and store in non-extreme conditions.
Suggest using the constant current power supply.

